

Folding pad eye - Dia 8 mm

Part #6605

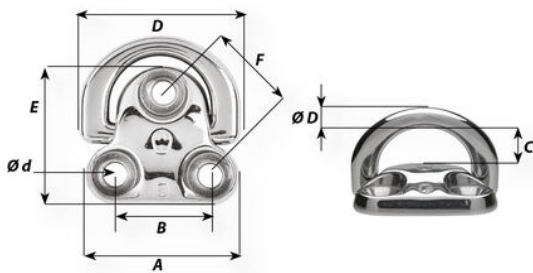

Description

Perfect solution for fastening applications (stay, blocks, jib tack point, lifeline, tether etc...)

Fully dropforged product with outstanding working and breaking loads regardless the angle of the load

Modern and optimized design to suit aesthetics of modern boats

They can be fold down to minimize the risk of injuries

The silicon pad eliminates noise and unpleasant vibrations

Modern design

Applications

For any fastening/attachment application: shroud, stay, blocks, lifeline, jib tack point etc...)

Technical information

Materials 17.4 pH stainless steel
316L stainless steel grade



Working load (kg)	2400
Breaking load (kg)	5000
Weight (g)	165
A (mm)	57
B (mm)	35
C (mm)	18
D (mm)	59
d diameter (mm)	8
D diameter (mm)	8
E (mm)	51
F (mm)	35

Caption



Working load (WL) : for nautical applications



Working Load Limit (WLL): for industrial applications only.

The safety factor is 5 times the breaking load.

WLL = Breaking load / 5

Wichard strives to ensure, to the best of its ability, the accuracy and the update of the information disseminated on this document, and reserves the right to correct at any time and without notice the content, as well as to evolve its products.

In the case of an industrial application, please contact our sales and technical department to validate the use of these products. The request for certificates can be made directly with the sales department when ordering the products.

Non-contractual pictures.